

# SPECIFICATION INFORMATION

# INSUL-JOINT™

**Expansion Joints**  
**Division: 03300**

Revision #1

## 1.0 Product Name

**Insul-Joint™**  
Expansion Joint Filler.

## 2.0 Manufacturer



**Insulation Solutions®**

Insulation Solutions Inc.  
401 Truck Haven Road  
East Peoria, IL 61611

Engineering Assistance  
Toll Free: 866-698-6562  
Fax: 309-698-0065  
[www.insulationsolutions.com](http://www.insulationsolutions.com)

## 3.0 Product Description

### 3.1 Basic Use:

**Insul-Joint™** is a closed cell, polyethylene, expansion joint filler designed to prevent cracks and breaks during concrete expansion and contraction. **Insul-Joint™** can be used in all standard concrete construction, such as

floor slabs, driveways, sidewalks, parking garages, highways and runways.

**Insul-Joint™** is designed with a perforated peel off top which allows for proper depth of sealants. The closed cell foam structure of **Insul-Joint™** resists water saturation which prevents the material from breaking down over time.

### 3.2 Composition & Materials:

**Insul-Joint™** is extruded from high quality closed cell polyethylene foam.

### 3.3 Size:

**Insul-Joint™** is 1/2 inch thick and is 50 feet in length. **Insul-Joint™** is available in multiple heights ranging from 3.5 inches to 8 inches.

### 3.4 Weight:

**Insul-Joint™** weighs approximately 2 pounds per roll.

## 4.0 Technical Data

### 4.1 Applicable Standards

American Society for Testing & Materials (ASTM)

- **ASTM D 1752** Standard Specification for Preformed Sponge Rubber Cork and Recycled PVC Expansion Joint Fillers for Concrete Paving and Structural Construction
- **ASTM D 4819** Standard Specification for Flexible Cellular Materials Made From Polyolefin Plastics
- **ASTM D 545-99** Standard Test Methods for Preformed Expansion Joint Fillers for Concrete Construction (Nonextruding and Resilient Types)
- **ASTM D 3575-00** Standard Test Methods for Flexible Cellular Materials Made From Olefin Polymers

*Note: To the best of our knowledge, these are typical property values and are intended as guides only, not as specification limits. Insulation Solutions Inc.® makes no warranties as to the fitness for a specific use or merchantability of products referred to, no guarantee of satisfactory results from reliance upon contained information or recommendations and disclaims all liability for resulting loss or damage.*

PROPERTIES	TEST METHOD	INSUL-JOINT™
<i>Test Results - Independent Test Facility</i>		<i>English</i>
Thickness, Nominal		0.5 inch
Weight Per Roll		2 lbs.
Classification	ASTM D 4819	TYPE II
Recovery	ASTM D 545-99	98.6%
Extrusion	ASTM D 545-99	0.16 inches
Compressive Strength Vertical Direction	ASTM D 545-99 Suffix D @ 50%	12.3 psi
Compression Set	ASTM D 3575-00 Suffix B	16%
Tensile Stress	ASTM D 3575-00 Suffix T MD/CMD	44 psi 26 psi
Elongation	ASTM D 3575-00 Suffix T MD/CMD	79% 65%
Tear Resistance	ASTM D 3575-00 Suffix G MD/CMD	10 lb/in 15 lb/in
Density Range	ASTM D 3575-00	1.7 lb/ft <sup>3</sup> (nominal)
Water Absorption	ASTM D 3575-00 Suffix L	<0.1 lb/ft <sup>2</sup>
Meets Application Requirements of: ASTM D 1752 Sections 5.1-5.4 (with the compression requirement modified to 10 psi minimum and 25 psi maximum)		

#### 4.2 Environmental Considerations:

**Insul-Joint™** contains no Chlorofluorocarbons (CFC) or Hydrochlorofluorocarbons (HCFCs).

#### 4.3 Physical Properties

**Insul-Joint™** is an extruded closed cell polyethylene foam expansion joint material. The closed cell foam structure allows the material to resist water saturation and allows the material to give during concrete expansion and contraction.

### 5.0 Installation

#### INSUL-JOINT™ PLACEMENT

- 5.1 **Insul-Joint™** is available in multiple heights ranging from 3.5 inches to 8 inches. The peel-off top feature is included in the total height of the material in order to be installed flush with the height of the concrete slab.
- 5.2 Level and tamp or roll granular base as specified by your architectural or structural drawings.
- 5.3 **Insul-Joint™** is positioned against the forms, at interrupting objects or columns and against abutting structures prior to the placement of concrete. **Insul-Joint™** shall extend the full slab depth unless otherwise indicated.
- 5.4 Using the peel-off top feature, position **Insul-Joint™** so that the top is even with the surface of the concrete. Align, plumb and level **Insul-Joint™** flush with adjacent surfaces. Fasten **Insul-Joint™** to substrate using a spray adhesive or mechanical fasteners.

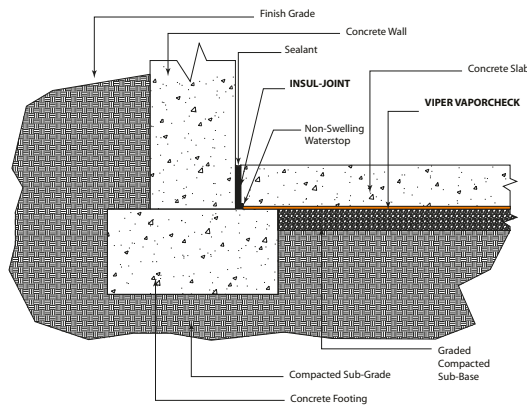

5.5 A minimum of 28 days after slabs have been placed and finished, simply remove the peel-off top to expose the sealant cavity.

5.6 Sealant cavities shall be clean, dry and free from foreign debris. Fill cavity with approved sealant. The sealant depth is usually 1/2 the width of the joint. Minimum joint depths are often 1/4" and the maximum depth for single-component sealants is 1/2". Refer to the sealant manufacturer's literature for more specific recommendations.

#### PROTECTION

- 5.7 No traffic shall be permitted to travel over sealed joints until sealing compound has properly cured.
- 5.8 Avoid storing **Insul-Joint™** outside for extended periods of time.

(These are very general installation instructions. Instructions on architectural or structural drawings should be reviewed and followed as well. Detailed installation instructions accompany each roll of **Insul-Joint™**).

### 6.0 Availability & Cost

**Insul-Joint™** is sold through construction supply houses across the United States and Canada.

**Insul-Joint™** current cost information can be obtained by calling our corporate sales office at 866-698-6562.

### 7.0 Warranty

To the best of our knowledge, the specification chart on page one lists typical property values and are intended as guides only, not as specification limits. INSULATION SOLUTIONS INC. MAKES NO WARRANTIES AS TO THE FITNESS FOR A SPECIFIC USE OR MERCHANTABILITY OF PRODUCTS REFERRED TO, NO GUARANTEE OF SATISFACTORY RESULTS FROM RELIANCE UPON CONTAINED INFORMATION OR RECOMMENDATIONS AND DISCLAIMS ALL LIABILITY FOR RESULTING LOSS OR DAMAGE.

### 8.0 Maintenance

**Insul-Joint™** requires no maintenance once installed.

### 9.0 Technical Services

Technical Information and detailed test results can be obtained by calling our corporate office at 866-698-6562.

### 10.0 Filing Systems

Additional Information is available from the manufacturer.