



EASYFLO

INSTALLATION INSTRUCTIONS

Read all instructions before proceeding. When using pneumatic roofing coil nailers, ensure the depth gauge is set to the minimum depth to penetrate at least 3/4 inch into the roof deck or completely through. The pressure should be set between 80 and 95 PSI.

Nails must be corrosion-resistant, 11 or 12 gauge, with heads at least 3/8 inch in diameter and comply with ASTM F1667. Use of ring shank nails may be required by some local building codes. All fasteners must be installed flush with the ridge vent surface and penetrate 3/4 inch into the wood deck or 1/8 inch through APA rated roof sheathing.

EasyFlo can be installed on roof pitches ranging from 2:12 to 18:12.

Follow the Occupational Safety and Health Admin (OSHA) safety standard for roofing.

Installation under the HVHZ requirements of the Florida Building Code.

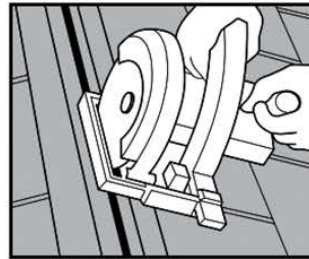

Fig. 1

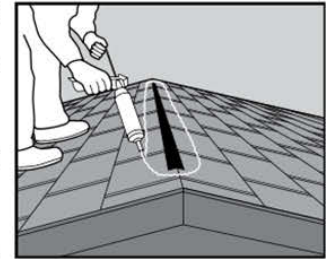

Fig. 2

STEP 1 - DETERMINING VENTILATION REQUIREMENTS

Determine the total required length of the ventilation slot according to the 1/150 rules (1 sq ft of ventilation area for each 150 sq ft of attic floor). For a balanced system, no more than 50% of the required ventilation should be installed at the ridge or hips.

STEP 2 - CUTTING THE VENT SLOT

- 1) Determine the type of roof framing that is used under the roof sheathing.
- 2) For roofs with a ridge board, cut a 1 in slot in the roof sheathing beyond each side of the ridge board. For an engineered truss roof, cut a 1 in slot on each side of the ridge (total slot width of 2 in).

Important: Start and end your cut 6 inches in from the rake edges (snapping chalk lines will aid in keeping a uniform ridge opening). Set your saw depth to cut the decking only. Do not cut into the roof framing. See Figure 1.

Note: The ventilation slot may be cut prior to or after shingle installation. If installing the slot on a roof with shingles installed, use of a circular saw with a carbide tip blade is recommended (Protective eye goggles should be worn during this process).

- 3) Expose the vent slot opening by removing the decking that was just cut between the rake edges. See Figure 1.

STEP 3 - INSTALL SHINGLES

Install shingles up to the ridge slot opening according to shingle manufacturer's instructions

STEP 4 - APPLY ASPHALT ROOFING CEMENT

With the shingles installed and the slot opening exposed, install a bead of asphalt roofing cement 3 inches below the vent slot opening on each side of the ridge, and at each end. The sealant should run the entire length of the ridge and should "picture frame" the slot. This will help fill any gaps between the vent and the shingles, particularly when using laminate shingles. See Figure 2.

Note: Use Asphalt Roofing Cement complying with ASTM D4586.

CONTINUED

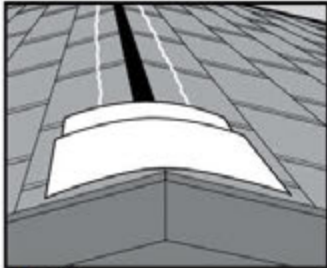

Fig. 3



Fig. 4

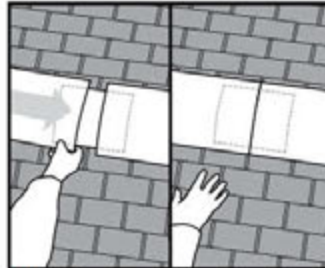

Fig. 5

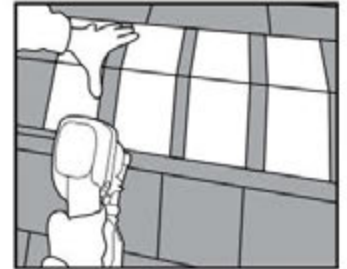

Fig. 6

STEP 5 - INSTALLING THE RIDGE VENT

1) Prior to installing EasyFlo, cut a minimum 6-inch wide hip & ridge shingle and nail it over the ridge at each rake edge. See Figure 3.

Note: For the best appearance run the ridge vent from rake edge to the rake edge.

2) Center EasyFlo over the slot opening and secure the starting end by applying one nail to the vent on each side of the ridge slot opening, nailing in the printed Tack Line.

3) Roll out the vent along the entire ridge, keeping it centered as you go. Once the vent is rolled out, remove any slack and nail the opposite end as described in the previous step.

4) Secure the vent along the entire ridge by nailing in the printed Tack Lines. One nail should be placed every 3 to 4 feet, on each side of the ridge. See Figure 4.

Note: Nails must penetrate at least 3/4 inch into the wood deck. If the deck is less than 3/4 inch thick the nail should be long enough to penetrate fully and extend 1/8 inch through the roof deck.

STEP 6 - CONNECTING EASYFLO

1) When two separate pieces of EasyFlo need to be joined together along the ridge, center a cap shingle directly under the location where the vent pieces will be joined together, and secure with 1 nail on each side of ridge.

2) Align the two vent pieces together without overlapping and then fasten by nailing each vent piece on both sides of the ridge to hold the vents in place. See Figure 5.

STEP 7 - HIP & RIDGE SHINGLE APPLICATION

1) Hip & ridge shingles should be installed from rake edge to rake edge, starting at the opposite end from which the prevailing winds blow.

2) Apply hip & ridge shingles over the ridge vent by centering the shingle over the vent.

Note: When nailing the shingles, ensure that corrosion-resistant, 11 or 12 gauge nails are used with heads at least 3/8 inch in diameter. All fasteners must be flush with the shingle surface and penetrate 3/4 inch into the wood deck or 1/8 inch through APA rated roof sheathing. Hip & ridge shingles should be installed per the shingle manufacturer's installation instructions. See Figure 6.